

Specification

| | |
|-----------------------------|----------------------------|
| Current Rating | :130mA (Max) |
| Voltage Rating | :150V DC/AC (Max) |
| Switching power | :5 VA (Max) |
| Contact Resistance | :25m Ohm Max.(initial) |
| Insulation Resistance | :100M Ohm Min. |
| Operating Force | :1kgf-cm(Max) |
| Indexing Angle | :30° |
| Operating Life non load | :20,000 CYCLES Min. |
| Operating Life at full load | :15,000 CYCLES Min. |
| Switching Mode | :Shorting and non shorting |
| Solder Specifications | :260 deg for 3 seconds |
| Operating Temperature | :-10deg~+60deg |

| | |
|----------------|---|
| Materials | |
| Cap | :Polyamide (PA) |
| Movement | :Polyamide (PA) |
| Case | :Polyamide (PA) |
| Fixed Contact | :Brass with gold plating |
| Moving Contact | :Phosphor bronze (PBS) with gold plating |
| Spring | :Stainless steel |

Dimension

Cap style A

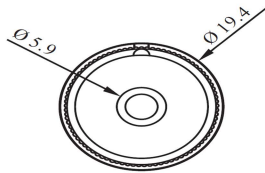

Cap style B

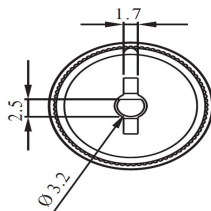

Cap style C

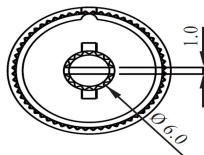
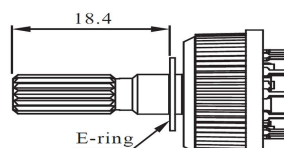
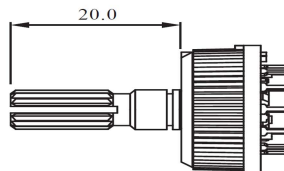
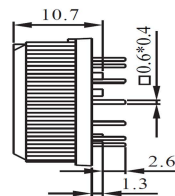
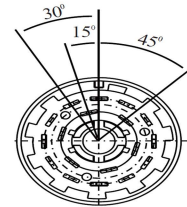
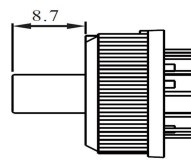
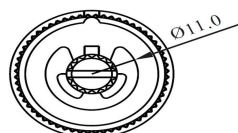
Cap style C1
(with E-ring)

P.C. Board layout & Contact configuration

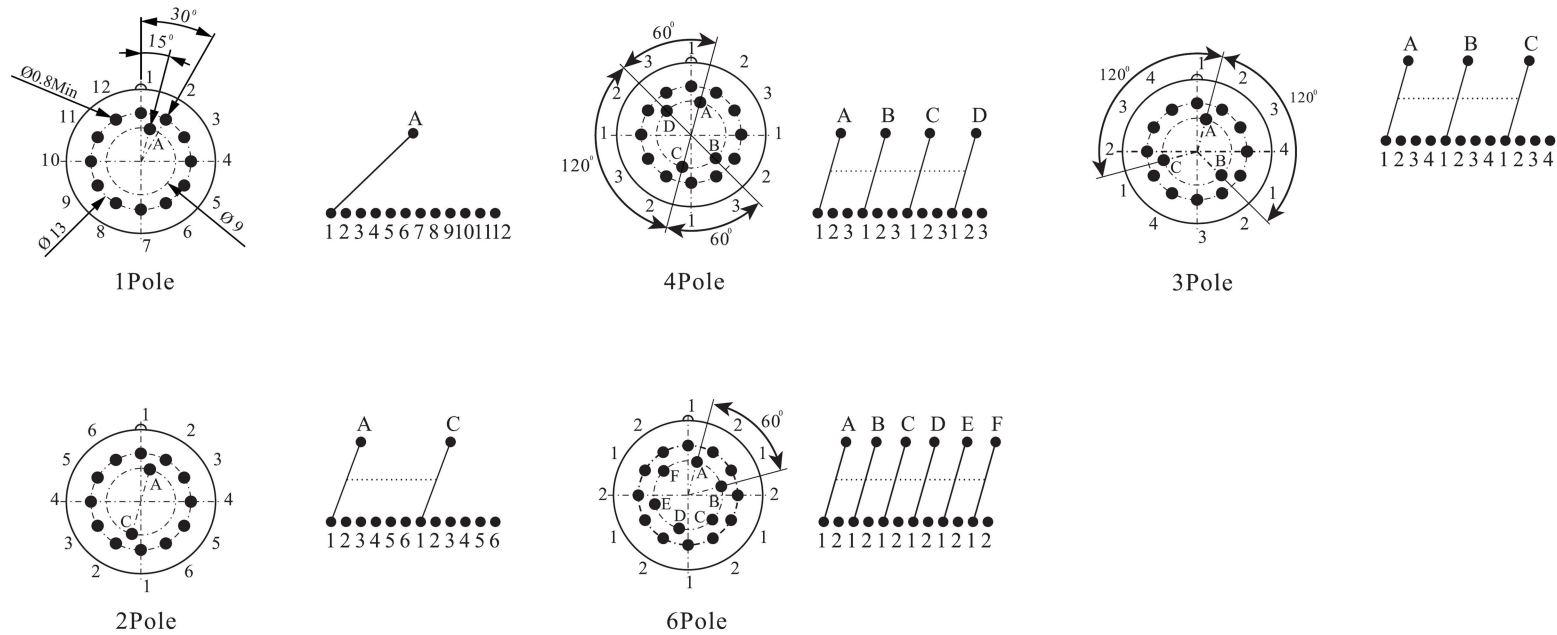

How to Order

S R S 5 — — —

| Cap Style | | Switching Combination | | |
|-------------------|--------------|---|--|--|
| A B C C1 | | 1Pole 11 1x2 12 1x12 13 Without stop | | |
| | | 2Pole 21 2x2 22 2x6 23 Without stop | | |
| | | 3Pole 31 3x2 32 3x4 33 Without stop | | |
| | | 4Pole 41 4x2 42 4x3 43 Without stop | | |
| | | 6Pole 61 6x2 63 Without stop | | |
| | | Operating Mode YS Shorting(make-before-break) NS Non-Shorting(break-before-make) | | |