

### SCHEMATIC

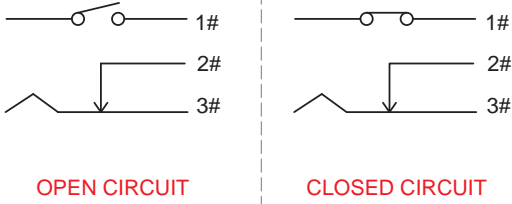

### SPECIFICATION

**RATING :** DC 15V 2A ; DC 16V 3A

**CONTACT RESISTANCE :** 30 mΩ MAX.

**INSULATION RESISTANCE :** 100 MΩ MIN.

**MECHANICAL LIFE :** 30,000 cycles.

### MATERIALS

**CASE&HOUSING:** Glass filled Nylon 6/6,black.

**ACTUATOR :** Glass filled Nylon 6/6,gray.

**CONTACT :** Copper alloy,silver plated.

**TERMINALS :** Copper alloy,silver plated.

**PIN :** Brass,nickel plated.



### MODEL OPTIONS



#### SPST

| Dimensions | PIN Ø A | Ø B   |
|------------|---------|-------|
| MODEL      |         |       |
| SJ-003     | ø2.00   | ø5.60 |
| SJ-006     | ø2.50   | ø5.60 |

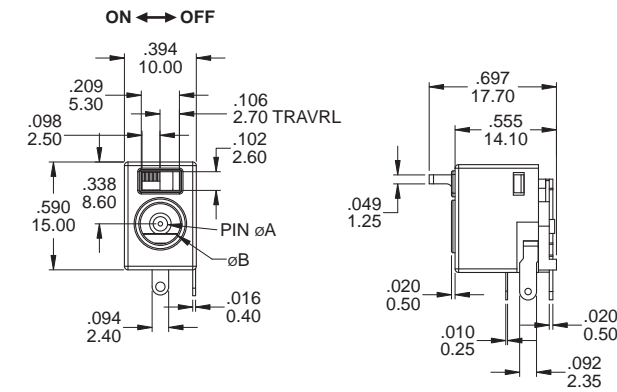

#### P.C.B LAYOUT Bottom View

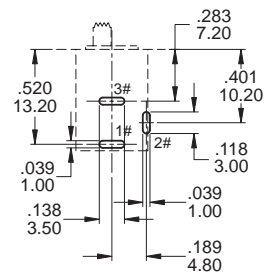

#### SPST

Part No. Shown : SJ-007

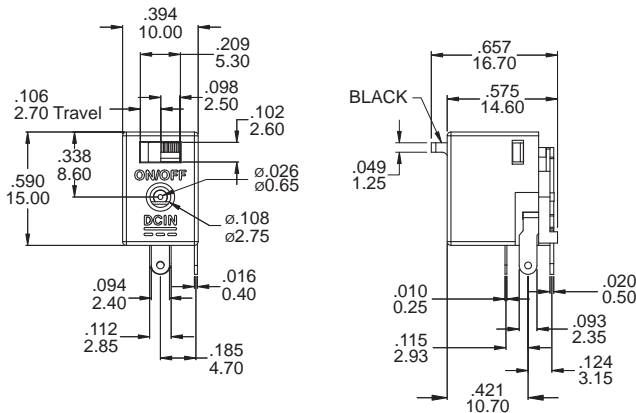

#### P.C.B LAYOUT Bottom View

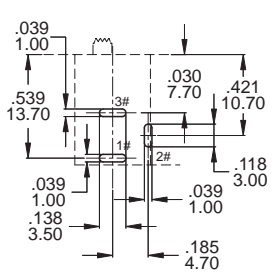

#### SPST

| Dimensions | PIN Ø A | Ø B   |
|------------|---------|-------|
| MODEL      |         |       |
| SJ-004     | ø2.00   | ø6.30 |
| SJ-005     | ø2.50   | ø6.50 |

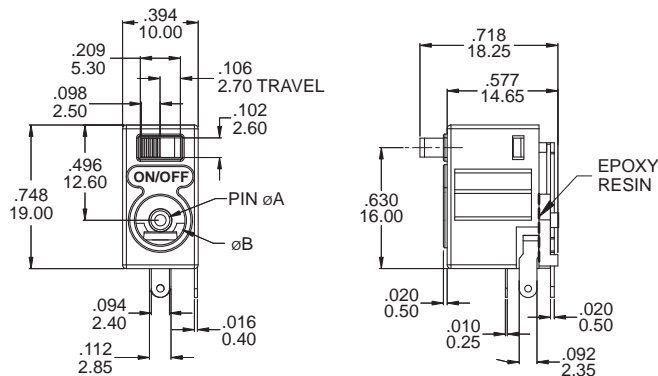

#### P.C.B LAYOUT Bottom View

