



## Specifications

Degree of Protection	IP 65 Watertight /Oiltight
Contact Configuration	Single Pole, Double Pole
Maximum Voltage	250V AC/DC
Thermal Current	5A
Minimum Applicable Load	5V AC/DC, 1mA
Contact Material	Gold-plated silver
Terminal Style	.110" Solder/Quick Connect
Operating Temperature	-25°C to +55°C
Operating Humidity	45 to 85% RH
Contact Resistance	50MΩ maximum
Insulation Resistance	100MΩ minimum (500V DC megger)
Vibration Resistance	10 to 55Hz, amplitude 1.2mm p-p
Degree of Protection	>10g
Electrical Life	100,000 operations minimum (at full rated load)
Mechanical Life	Maintained: 1,000,000 operations minimum Momentary: 1,000,000 operations minimum Selecotr /Keylock: 250,000 operations minimum
Dielectric Strength	Switch Unit: 2,000V AC, 1min. between live/dead part and terminals of different poles; 1,000V AC, 1 minute between terminals of the same pole; 1,500V AC, 1 minute between contact and lamp terminals. Illumination Unit: 2,000V AC, 1min. between live Part/ground
Soldering Temperature	20W/5 Seconds or 260C/3 seconds

## Contact Ratings

Working voltage		24V	110V	220V
AC (50/60Hz)	Resistive	—	1.0A	0.5A
	Inductive	—	0.7A	0.5A
DC	Resistive	1.0A	0.2A	—
	Inductive	0.7A	0.1A	—

## LED Ratings

Rated Voltage	Current
5V DC ± 5%	8mA
6V AC/DC (± 10%)	AC: A, R, W, Y: 8mA G, S: 7mA DC: A, R, W, Y: 6mA G, S: 5mA
12V AC/DC (± 10%)	AC: 9mA DC: 8mA
24V AC/DC (± 10%)	AC: 9mA DC: 8mA

## How to Order

RJSPS16A -



Operation Characteristic

Lamp Style

Voice style





Voltage

Round  
Rectangular

Basic  
Red LED

Continuous  
Discontinuous

6.3VDC  
12VDC  
24VDC  
110VDC  
220VDC

Product appearance	Illuminated type	Model
Round  	Without LED	RJSPS16A Round Buzzer
	With LED	RJSPS16A Round Buzzer with LED
Rectangle  	Without LED	RJSPS16A Rectangular Buzzer
	With LED	RJSPS16A Rectangular Buzzer with LED

Round

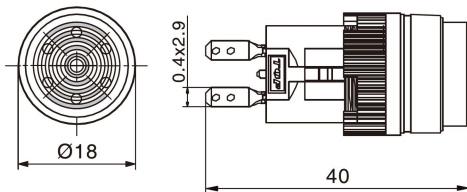

□ Buzzer Installation size

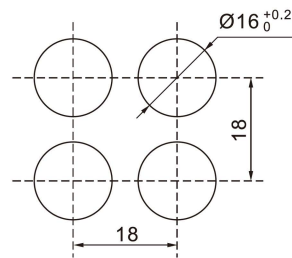

□ Contacts circuit

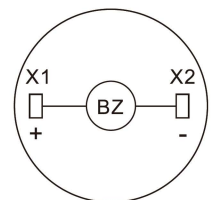

Rectangle

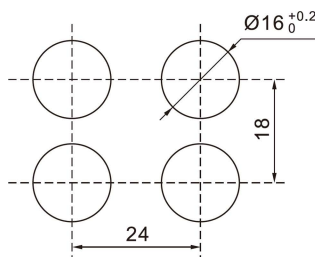
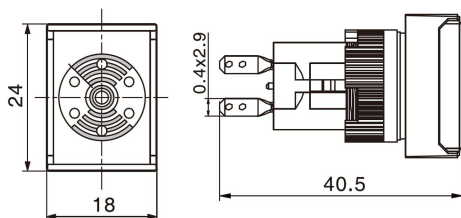

Rectangle