

RJS203-40L SERIES

METAL PUSH BUTTON SWITCH

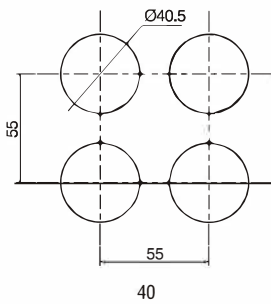

Install Size



Switching Operation

Type	Sign	Diagram	Contact type	Terminal Description
No.2				

Explanation: Using two terminals, double-break and slow-motion contact.

Y type NC switch can be made to order for individual product, pls check the product description.

LED Ratings

Lamp Type	LED lamp(AC/DC)
Rated Voltage	3V,6V,12V,24V,36V,48V,110V,220VAC/DC
Rated Current	15mA - 20mA
LED Colour	R G Y O B W
Life	40000 hours(Reference)
Lamp Circuit diagram	<p>Using AC/DC LED lamp, the terminals have no difference of anode and cathode</p>

DC LED and other voltage can be made to order.

Rated Parameters

		Working voltage	24V	110V	220V
Contact Parameter	AC (50/60Hz)	—	1.0A	0.5A	0.5A
	DC	1.0A	0.2A	—	—
			0.7A	0.1A	—





Contact Ratings

Rated insulation voltage		250				
Heating current Ith		3A				
Rated voltage		Temperature does not exceed the maximum allowed current				
		12V	24V	110V	220V	
Rated current	AC 50/60Hz	Resistive load	—	—	5A	3A
		Inductive load	—	—	3A	2A
	DC	Resistive load	5A	5A	1A	0.5A
		Inductive load	2A	2A	0.2A	0.1A
Contact material		Silver Plated Gold				

RJS203-40L SERIES

METAL PUSH BUTTON SWITCH



Appearance	Shape of top	Illuminated type	Operation	Contact	Model	Colour	Voltage	Crust material
	High ring round	With LED	Momentary	2NO+2NC	RJS203-40L-H-R-67J	<ul style="list-style-type: none"> ■ Red ■ Green ■ Blue ■ White ■ Yellow ■ Orange 	<ul style="list-style-type: none"> 24VDC 12VDC 6.3VDC 110VAC 220VAC 	BS: Stainless Steel
	Flat ring round	With LED	Momentary	2NO+2NC	RJS203-40L-F-R-67J			
	Flat dot round	With LED	Momentary	2NO+2NC	RJS203-40L-F-D-67J			
	Domed ring round	With LED	Momentary	2NO+2NC	RJS203-40L-B-R-67J			

RJS203-40L-H-R-67J



2Pole

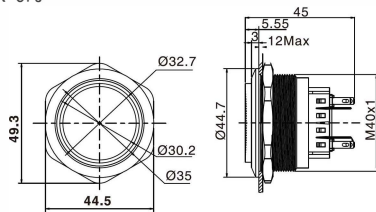

RJS203-40L-F-R-67J



2Pole

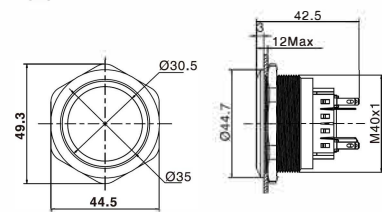

RJS203-40L-F-D-67J



2Pole

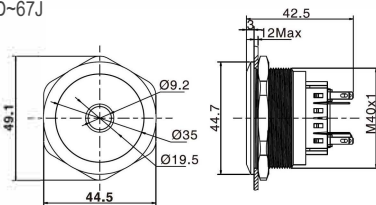

RJS203-40L-B-R-67J



2Pole

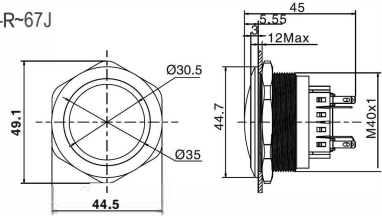

Wiring available subject to MOQ



RJS203-40L SERIES

METAL PUSH BUTTON SWITCH



How to Order

Corresponding number	RJS 03 - L(A) - H - R ~ 67 J								
	1	2	3	4	5	6	7	8	9
1	Poles	1 / 2							
2	Size	22 / 25 / 30 / 40 mm							
3	Function	Momentary / Latching							
4	Shape of Top	Flat / High / Domed / Mushroom Head / Full-face illumination							
5	Illumination Type	Ring / Dot / Custom							
6	Colour								
7	Material	Stainless Steel / Black Anodised Aluminium / Other metal finishes *							
8	Voltage	24VDC 110VAC		12VDC 220VAC		6.3VDC			
9	IP Rating	IP65 / IP67							