



RJS1N1-19

■ 19mm Non-LED Illuminated Push Button Switch

Product Appearance	Part Number	Operations	Contact	Material	Colour	Rated Voltage / Current
	RJS1N1-19L-F~65Q	Momentary	1NO1NC	Stainless Steel Black Anodised Aluminium	R Red G Green Y Yellow W White B Blue O Orange	LED NON-RESISTED 1.8 - 3V Resisted 5V / 12V / 24V 110 VAC / 250VAC AC:250V / 5A LED: AC/DC: 1.8-250V <20mA
	RJS1N1-19L-B~65Q					
	RJS1N1-19L-H~65Q					

■ Drawing

IP65



RJS1N1-19L-F~65Q

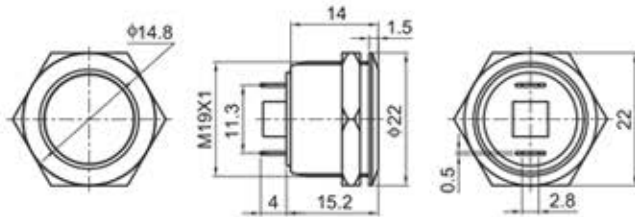

IP65



RJS1N1-19L-B~65Q

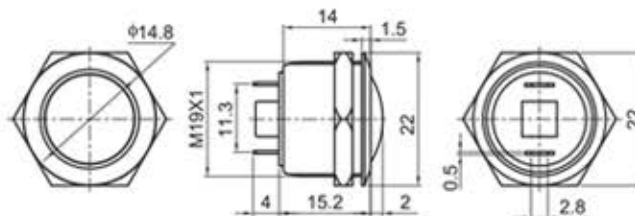

IP65



RJS1N1-19L-H~65Q

