



- Hole sizes: 22mm
- Protection level: IP65/IP67/IK10
- Contact silver-plated gold: 1.5μ
- LED super bright cold light source lamp display
- Dedicated special frosted stainless steel ring
- Overall beautiful, high-class and fashionable
- Comply with IEC60947-5-1 GB14048.5 standard

Specifications

Degree of Protection	IP67 /IP65
Contact Type	1NO
Maximum Voltage	250V AC/DC
Thermal Current	5A
Minimum Applicable Load	5V AC/DC, 1mA
Contact material	Silver plated glod
Terminal Style	.110" Solder / Quick Connect
Operating Temperature	-25°C to +55°C

Operating Humidity	45 to 85% RH
Contact Resistance	50mΩ
Insulation Resistance	100mΩ minimum (500VDC megger)
Vibration Resistance	10 to 55Hz, amplitude 1.5mm p-p
Degree of Protection	>10g
Electrical Life	100,000 operations minimum (at full rated load)
Mechanical Life	Latching : 1,000,000 operations minimum Momentary: 1,000,000 operations minimum
Dielectrical Life	Switch Unit: 2,000V AC, 1 min. between live/dead part and terminals of different poles; 1,000V AC, 1 minute between terminals of the same pole; 1,500V AC, 1 minute between contact and lamp terminals. Illumination Unit: 2,000V AC, 1 min. between live part/ground
Soldering Temperature	20W/5 seconds or 260°C/3 seconds

LED Rating

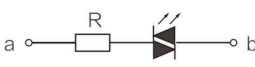
Lamp Type	LED lamp(AC/DC)
Rated Voltage	3V,6V,12V,24V,36V,48V,110V,220VAC/DC
Rated Current	15mA - 20mA
LED Color	R G Y O B W
Life	40000 hours(Reference)
Lamp Circuit diagram	 <p>Using AC/DC LED lamp, the terminals have no difference of anode and cathode</p>

DC LED and other voltage can be made to order.

Contact Rating

Rated insulation voltage			250V		
Heating current I _{th}			3A Temperature does not exceed the maximum allowed current		
Rated voltage			24V	110V	220V
Rated current	AC 50/60Hz	Resistive load	2A	-	-
		Inductive load	-	1A	0.5A
	DC	Resistive load	0.7A	0.2A	0.1A
		Inductive load	-	-	-
Contact material			Silver nickel oxide		Silver Plated Gold

Panel Cut-Out

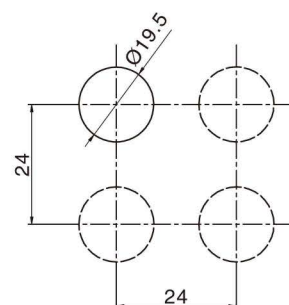

Switching Operation

Type	Sign	Diagram	Contact type	Terminal Description
No.2				

Explanation: Using two terminals, double-break and slow-motion contact. Y type NC switch can be made to order for individual product, pls check the product description.

Select and Key Handle Position

Operation	Contact	↙	↑	↗
90° 2 2 Positon	SPDT			
	DPDT			
90° 3 3 Positon				

Drawing



Selector Switch

Illuminated type	Operation	Contact	Part Number	Colour	Voltage	Material
Without LED	90° 2 2 Positon	1NO+1NC	RJS102-22S-441-0-67J	<div><div>Red</div><div>Green</div><div>Blue</div><div>White</div><div>Yellow</div><div>Orange</div></div>	24VDC 12VDC 6.3VDC 110VAC 220VAC	Stainless Steel Copper Plated
		2NO+2NC	RJS102-22S-412-0-67J			
	90° 3 3Positon	2NO+2NC	RJS102-22S-512-0-67J			
	90° 2 2 Positon	1NO+1NC	RJS102-22S-411-2-67J			
		2NO+2NC	RJS102-22S-412-2-67J			
	90° 3 3Positon	2NO+2NC	RJS102-22S-512-2-67J			
With LED	90° 2 2 Positon	1NO+1NC	RJS102-22S-L-R-471-0-67J			
		2NO+2NC	RJS102-22S-L-R-472-0-67J			
	90° 3 3Positon	2NO+2NC	RJS102-22S-L-R-571-2-67J			
	90° 2 2 Positon	1NO+1NC	RJS102-22S-L-R-572-2-67J			
		2NO+2NC	RJS102-22S-L-R-472-2-67J			
	90° 3 3Positon	2NO+2NC	RJS102-22S-L-R-572-2-67J			

