

LED Indicators - RJS01 Series

■ Features

- 6/8/12/16/19/22/28/30mm
- IP65/IP67/IK10

■ Standard

IEC60947-5-1 GB14048.5
Conform to IEC60947-5-1 GB14048.5 Standard

■ Technical Specifications





LED Voltage	Operating Voltage Vop (Min to Max)	Operating Current Iop (Typical All Typs)
2VDC (No Resistor)	1.8-2.5VDC	20mA
12VDC	10.8-13.2VDC	20mA
24VDC	21.6-26.4VDC	20mA
28VDC	25.2-30.8VDC	20mA
110VAC	99-121VDC	6mA
230VAC	207-253VDC	3mA

Intensity(Typical) at Iop Standard	Prominent (all voltages)	Flush (all voltages)
Red	7,500mcd	2000mcd
Green	4,100mcd	250mcd
Yellow	2,500mcd	350mcd
Blue	1,300mcd	300mcd
White	1,900mcd	200mcd

Luminous intensity will be reduced with lower operating current.

Max Reverse Voltage	5V
Viewing Angle	100° (dependant on mode)
Life Expectancy	50, 000 hours
Operating Temperature Range	-40~+85℃





■ How to Order

RJS01-		-							
Install Size	Action Style:	Shape of Top:	Contact Type:	Install Style:	Color:	Voltage:	Material:		
6mm 8mm 12mm 16mm 19mm 22mm 28mm 30mm	Pilot lamp	3:Domed 5:Concove 6:High 7:Flat	0: Non	A: Screw Type P: PCB Type	 Red  Green  Blue  White  Yellow	D:24VDC E:12VDC F:6.3VDC A1:110VAC A2:220VAC	Nil:Stainless steel T: Copper Plated Ni G:Copper plated Cr		

Note: The regular material is Stainless steel, if you want Copper Plated with Ni ,please add T behind ,if you want Copper Plated Cr , please add G behind.



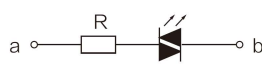

■ LED Parameter

Lamp Type	LED	LED lamp(AC/DC)
Rated Voltage	AC/DC6V	AC/DC12V AC/DC6V V AC/DC12V
Rated Current	15mA	About 15mA
LED Color	    	
Life	40000 hours(Reference)	
Lamp Circuit diagram	 <p>Using AC/DC LED lamp, the terminals have no difference of anode and cathode: Using inner resistance, do not need connect outer resistance. MP16 haven't inner resistance, need connect outer resistance.</p>	

DC LED and other voltage can be made to order.

LED Indicators - RJS01 Series

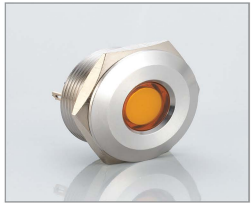
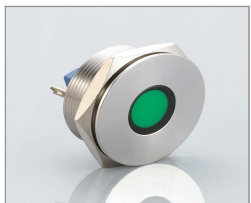
■ RJS01-28I~67J

Product appearance	Install Style	Model	Color	Rated Voltage	Crust Material
Concave Round 	PCB TYPE	RJS01-28I-150P~67J	<div> ■ Red ■ Green ■ Yellow ■ White ■ Blue </div>	D:24VDC E:12VDC F:6.3VDC A1:110VAC A2:220VAC	Nil:Stainless steel T: Copper Plated Ni G:Copper plated Cr
Flat Round 		RJS01-28I-170P~67J			
Concave Round 	Screw Type	RJS01-28I-150A~67J			
Flat Round 		RJS01-28I-170A~67J			

RJS01-28I-150P~67J

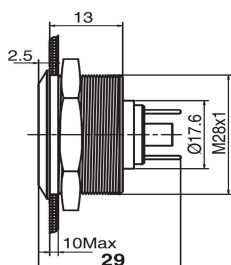
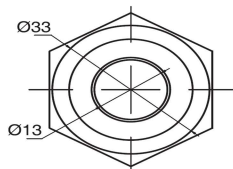

RJS01-28I-150A~67J

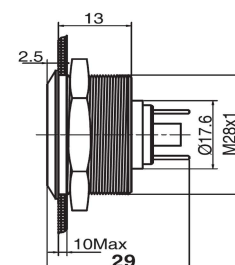
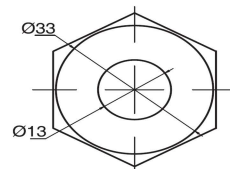

RJS01-28I-170P~67J

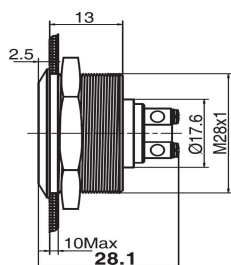
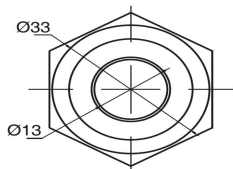

RJS01-28I-170A~67J

