

# ML SERIES

## LED PUSH BUTTON SWITCH

**Feature :**

- Bi-color LED illuminated available
- 2P2T, 4P2T
- Lock / non-lock function

**Application :**

- Computer products
- Instrumentation
- Communication equipments



SWITCH SPECIFICATIONS	
POLE - POSITION	2P2T , 4P2T LOCK / NON-LOCK Action with LED
CONTACT RATING	30 V DC , 0.3 A
CONTACT RESISTANCE	20 mΩ MAX. 1.5 V DC ; 100 mA by Method of Voltage DROP
INSULATION RESISTANCE	100 MΩ MIN. 500 V DC
DIELECTRIC STRENGTH	Breakdown is not Allowable ; 500 V AC for 1 Minute
OPERATING FORCE	200 ± 100 gf
OPERATING LIFE	10,000 cycles
OPERATING TEMPERATURE RANGE	-20°C ~ 70°C
TOTAL TRAVEL	TRAVEL : 2.5 ± 0.3 mm TRAVEL : 3.3 ± 0.3 mm

LED SPECIFICATIONS								
ATTENTION LEDs are Electrostatic Sensitive devices  (+) (-)	Unit	Value / LED Color						
		Blue	Pure Green	Red	Yellow	Orange	Green	White
LUMINOUS INTENSITY@20mA Iv	mcd	900	6500	900	1300	900	400	1200
Dominant Wavelength λD	nm	470	525	635	590	601	570	/
FORWARD VOLTAGE@20mA Vf	V	3.2	3.3	1.95	2	2.1	2.1	4

■ A single bin cannot be ordered, please contact us in advance if you need a particular bin sorting before placing your order to clarify the lead time, MOQ and pricing

### ▶ HOW TO ORDER

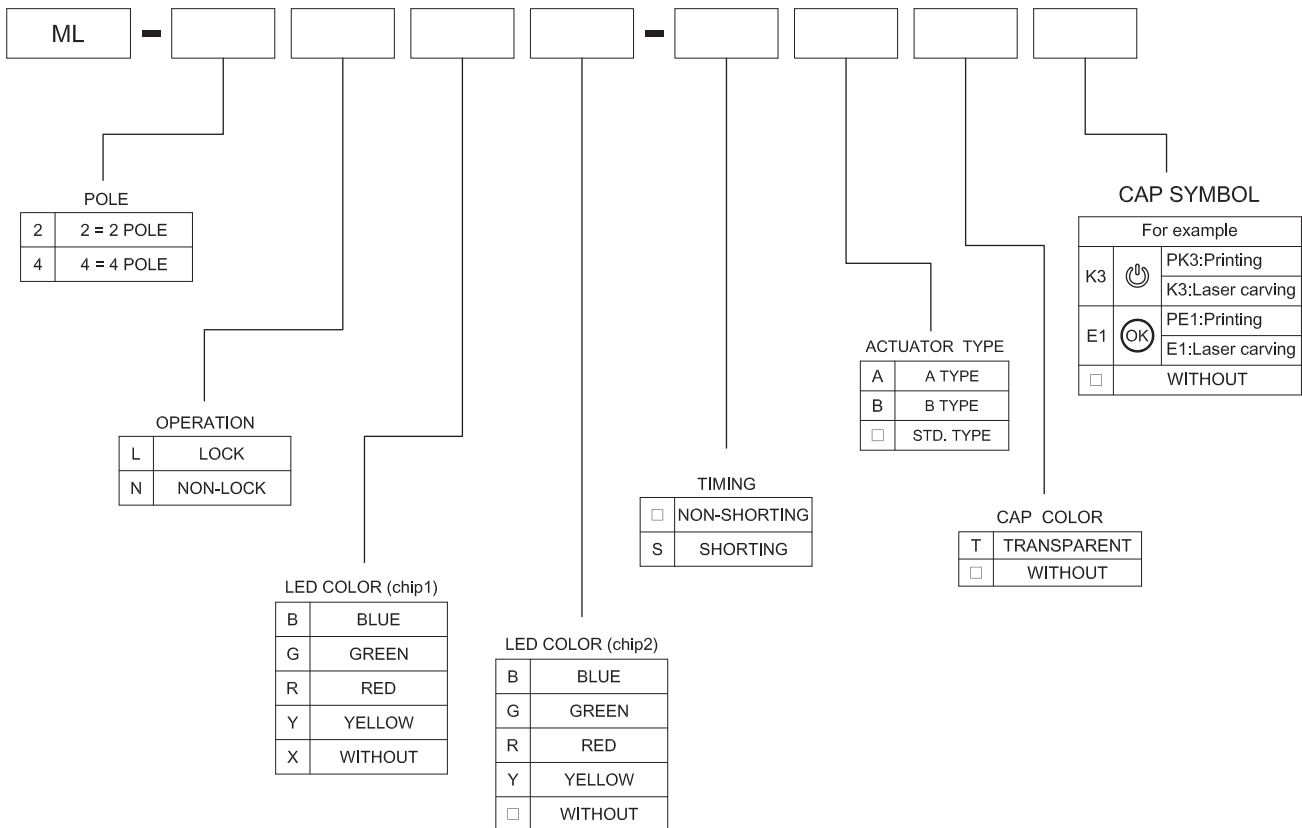

# ML SERIES

LED PUSH BUTTON SWITCH

RJS Electronics Ltd



## ► DIMENSION

ML - 2N □ □

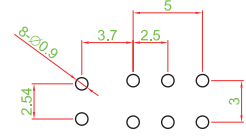
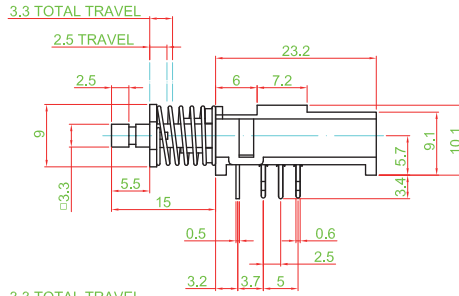
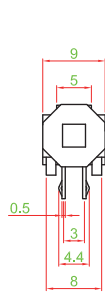
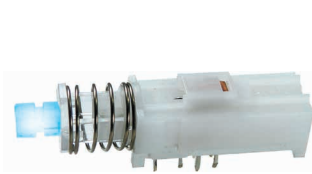

ML - 4N □ □

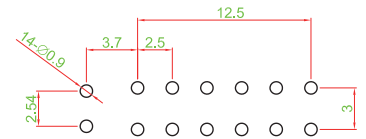
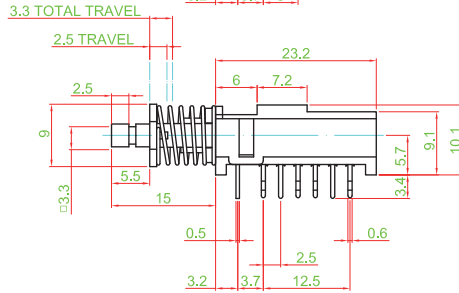
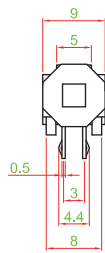
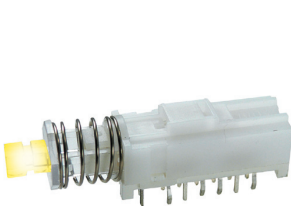

## ► ACTUATOR TYPE

A TYPE

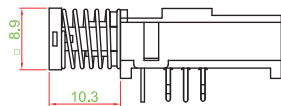
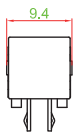
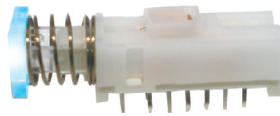

B TYPE

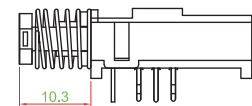
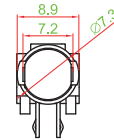

## ► CAP TYPE

AT TYPE

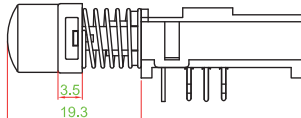
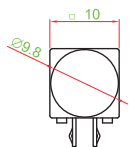

BT TYPE

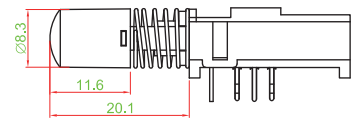
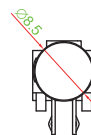

## ► CIRCUIT

2 POLE

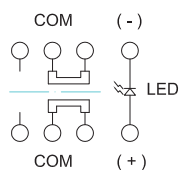

4 POLE

