

3L LED Indicator

Updated gorgeous design.

Soft and bright illumination makes up the panels beautiful.

Bright and Various illumination (Mono-color, Split-face, Dual-color, Negative) with R-shaped clear cover, makes easy planning of multiple design.

■ FEATURES

- Size : 30mm square type.
30×62mm rectangular type.
- Depth behind panel : Only 28mm (Connector type)
- Illumination : Mono-Color, Split-Face, Dual-Color, Negative
- Terminal : Connector Type, Screw Type
- Supply Voltage : DC5V, 12V, 24V, 48V
(12, 24, 48V=Both AC/DC possible to use)
- Low bright type (Mono-color only)

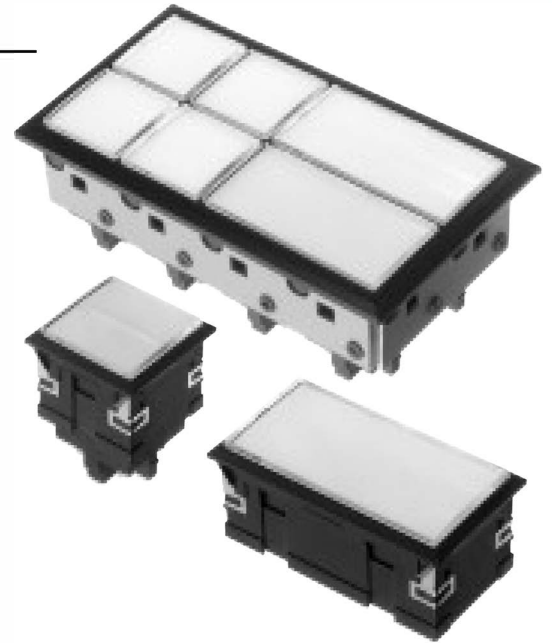

SPECIFICATIONS

Insulation Resistance	More than 100MΩ at 500V DC
Dielectric Strength	2000V AC RMS between terminals and ground (50/60Hz for 60sec. at normal ambient temperature and humidity)
Ambient Temperature	-10°C~+40°C
Ambient Humidity	45~80% RH

LED DATA



	Supply Voltage (V) ±5%	Current Rating (mA)															
		Mono-color				Mono-color(low bright)				Dual-color				Split-Face			
		R/Y	G	SB/SG	SW	R/Y	G	SB/SG	SW	R/Y	G	SB/SG	SW	R/Y	G	SB/SG	SW
30mm square	DC5V	50	70	34	40	30	40	20	24	50	70	34	40	25	35	17	22
	AC/DC12V	22	26	18	22	12	16	10	12	22	26	18	22	11	13	9	11
	AC/DC24V	11	13	9	11	6	8	5	6	11	13	9	11	11	13	9	11
	AC/DC48V	11	13	9	11	6	8	5	6	11	13	9	11	11	13	9	11
30×62mm Rect.	DC5V	100	140	68	75	60	80	40	48	100	140	68	75	50	70	34	40
	AC/DC12V	44	52	36	44	24	32	20	24	44	52	36	44	22	26	18	22
	AC/DC24V	22	26	18	22	12	16	10	12	22	26	18	22	11	13	9	11
	AC/DC48V	11	13	9	11	6	8	5	6	11	13	9	11	11	13	9	11

3L LED Indicator

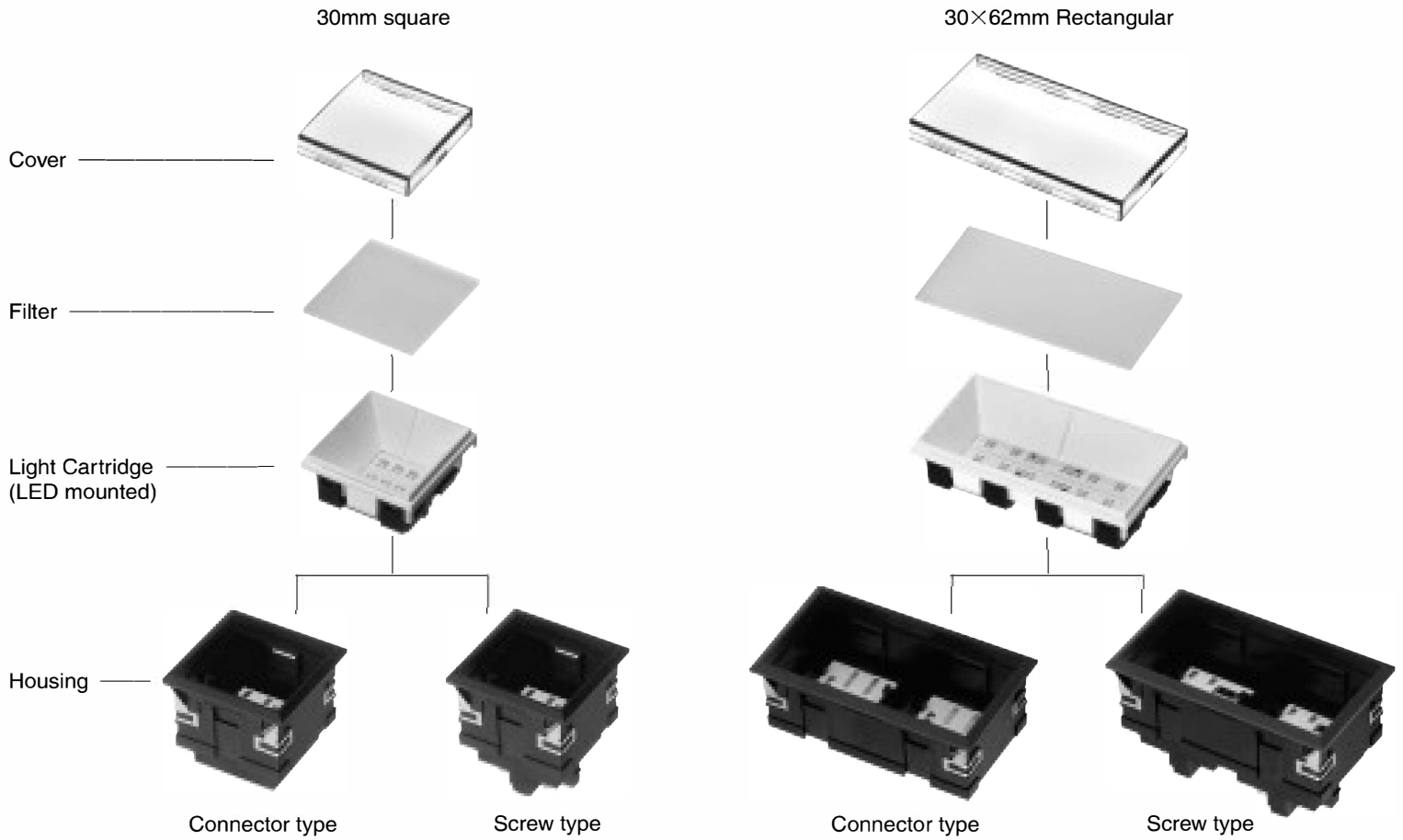
STRUCTURE

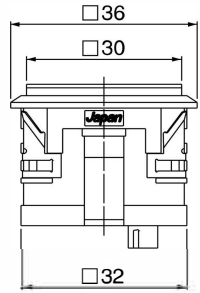
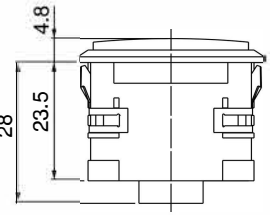
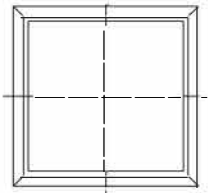

DIMENSIONS

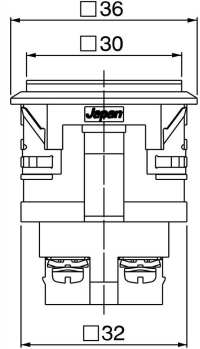
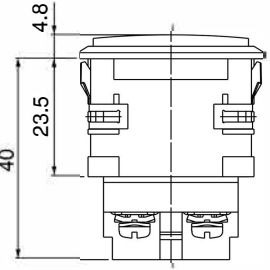
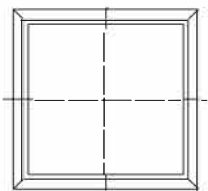
<p>30mm square, Connector type</p> 			 <p>Top View</p>
<p>30mm square, Screw type</p> 			 <p>Top View</p>

Tolerance : ±0.4mm

3L LED Indicator

DIMENSIONS

30×62mm Rect. Connector type

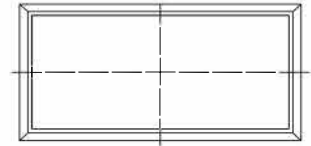
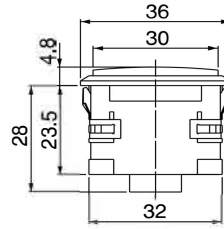
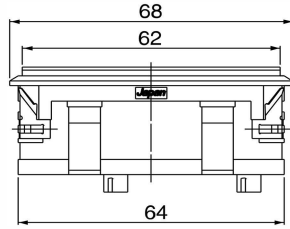

Top View

30×62mm Screw type

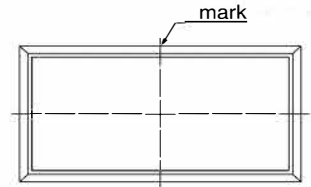
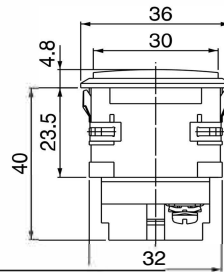
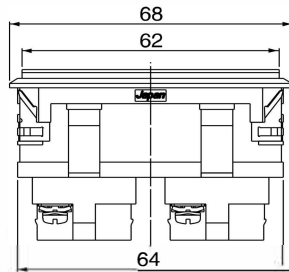

Top View

Panel Thickness : 1mm~6mm

Matrix Mounting
(with Matrix Frame)

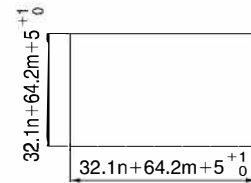
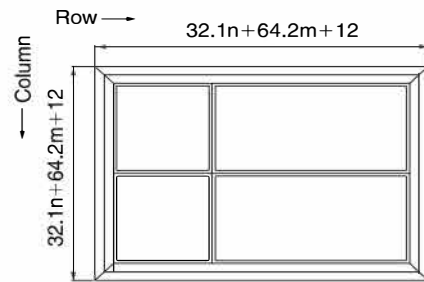
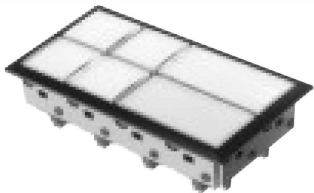

Panel Cut Dimension

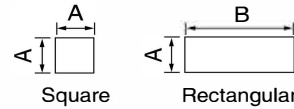

※ n : Number of A size (Row/Column)
m : Number of B size (Row/Column)

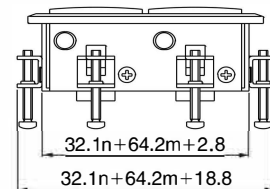
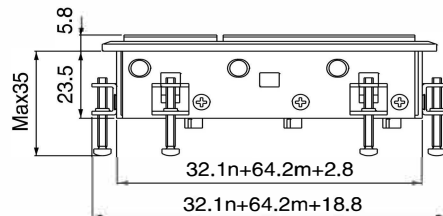

Connector

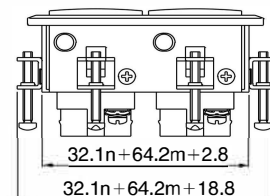
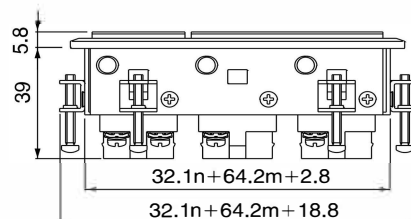

Screw

Tolerance : ±0.4mm

3L LED Indicator

INTERNAL CONNECTION ARRANGEMENTS

● 30mm square

	DC 5V	AC/DC 12V, 24V, 48V
Mono-color	<p>Two diagrams showing internal connections for a mono-color LED indicator on DC 5V. The top diagram shows a single LED with a resistor and a 'mark' on the LED. The bottom diagram shows a 4-pin connector with terminals 1, 2, 3, and 4, and the internal LED and resistor circuit.</p>	<p>Two diagrams showing internal connections for a mono-color LED indicator on AC/DC 12V, 24V, or 48V. The top diagram shows a bridge rectifier circuit with a single LED and a resistor. The bottom diagram shows a 4-pin connector with terminals 1, 2, 3, and 4, and the internal bridge rectifier and LED circuit.</p>
※ Mono-color (low bright)	<p>Diagram showing internal connections for a mono-color (low bright) LED indicator on DC 5V. It features a single LED with a resistor. Connections are labeled: 'to 1 or x1' and 'to 3 or x3' at the top, and 'to 2 or x4' and 'to 4 or x2' at the bottom.</p>	<p>Diagram showing internal connections for a mono-color (low bright) LED indicator on AC/DC 12V, 24V, or 48V. It features a bridge rectifier circuit with a single LED and a resistor. Connections are labeled: 'to 1 or x1', 'to 2 or x4', 'to 3 or x3', and 'to 4 or x2'.</p>
Dual-color	<p>Diagram showing internal connections for a dual-color LED indicator on DC 5V. It features two LEDs with resistors. Connections are labeled: 'to 1 or x1', 'to 3 or x3', and 'to 4 or x2'.</p>	<p>Diagram showing internal connections for a dual-color LED indicator on AC/DC 12V, 24V, or 48V. It features a bridge rectifier circuit with two LEDs and resistors. Connections are labeled: 'to 1 or x1', 'to 2 or x4', 'to 3 or x3', and 'to 4 or x2'.</p>
Split-face	<p>Diagram showing internal connections for a split-face LED indicator on DC 5V. It features two LEDs with resistors. Connections are labeled: 'to 1 or x1', 'to 3 or x3', and 'to 4 or x2'.</p>	<p>Diagram showing internal connections for a split-face LED indicator on AC/DC 12V, 24V, or 48V. It features a bridge rectifier circuit with two LEDs and resistors. Connections are labeled: 'to 1 or x1', 'to 2 or x4', 'to 3 or x3', and 'to 4 or x2'.</p>

※ In case of Mono-color, low bright type, please provide like a following circuit to prevent the current flow to another circuit.

(example)

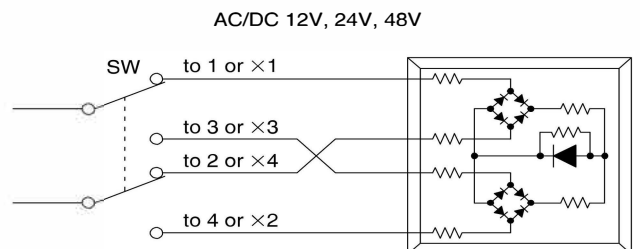
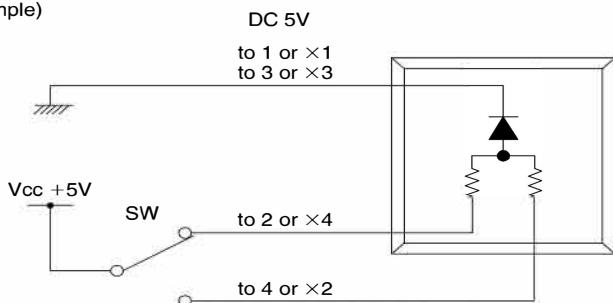

3L LED Indicator

INTERNAL CONNECTION ARRANGEMENTS

● 30×62mm Rectangular

	DC 5V	AC/DC 12V, 24V, 48V
Mono-color		
※ Mono-color (low bright)		
Dual-color		
Split-Face (Vertical)		
Split-Face (Horizontal)		

※ Please refer previous page.

3L LED Indicator

TERMINAL LAYOUT

CONNECTOR
30mm square

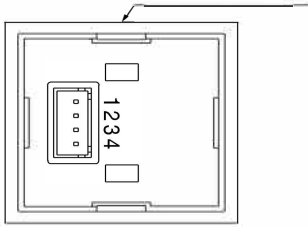

30×62mm Rectangular

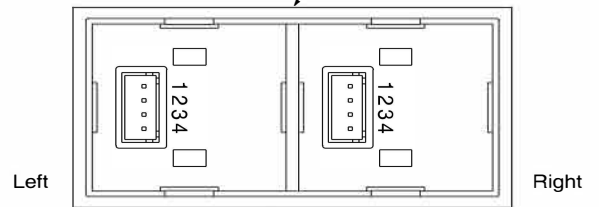

SCREW
30mm square

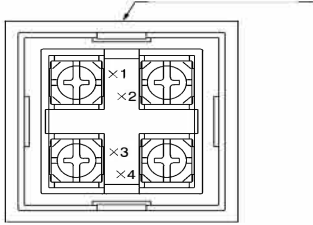

30×62mm Rectangular

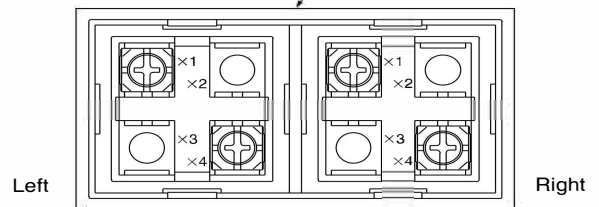

● 30mm square

Term. No.		Mono-color		Mono-color(low bright)			Dual-color			Split-face		
Con.	Scw.	5V	12, 24, 48V	Br.	5V	12, 24, 48V		5V	12, 24, 48V		5V	12, 24, 48V
1	×1	Cathode	Anode/Cathode	std.	Cathode	Anode/Cathode	No.1	Cathode	Anode/Cathode	Upper	Cathode	Anode/Cathode
2	×4	Anode	(no polarity)		Anode	(no polarity)	(※1)	Anode	(no polarity)		Anode	(no polarity)
3	×3	—	—	low	Cathode	Anode/Cathode	No.2	Cathode	Anode/Cathode	Lower	Cathode	Anode/Cathode
4	×2	—	—		Anode	(no polarity)	(※2)	Anode	(no polarity)		Anode	(no polarity)

● 30×60mm Rectangular

Term. No.(※5)		Mono-color		Mono-color(low bright)			Dual-color			Split-face (Vert.)			Split-face (Horiz.)		
Con.	Scw.	5V	12, 24, 48V	Br.	5V	12, 24, 48V		5V	12, 24, 48V		5V	12, 24, 48V		5V	12, 24, 48V
Right 1	Right×1	Cathode	Anode/Cathode	std.	Cathode	Anode/Cathode	No.1	Cathode	Anode/Cathode	Left	Cathode	Anode/Cathode	Upper	Cathode	Anode/Cathode
Right 2	Right×4	Anode	(no polarity)		Anode	(no polarity)	(※1)	Anode	(no polarity)		Anode	(no polarity)		Anode	(no polarity)
Left 1	Left×1	—	—	low	Cathode	Anode/Cathode	No.2	Cathode	Anode/Cathode	Right	Cathode	Anode/Cathode	Lower	Cathode	Anode/Cathode
Left 2	Left×4	—	—		Anode	(no polarity)	(※2)	Anode	(no polarity)		Anode	(no polarity)		Anode	(no polarity)

※1. Please refer (ORDERING CODE). No.1 = Frame 1

※2. Please refer (ORDERING CODE). No.2 = Frame 2

※3. Please refer (ORDERING CODE), figure of split-face. (Window No. 1)

※4. Please refer (ORDERING CODE), figure of split-face. (Window No. 2)

※5. Regarding as "Right/Left", please refer (INTERNAL CONNECTION ARRANGEMENTS) AND (TERMINALS LAYOUT)

Panel Layout/Panel Cut Dimensions

Panel Thickness : 1mm~4mm

	Panel Layout	Panel Cut Dimensions
30mm square		
30×62mm Rectangular		
30×62mm Rectangular		

n : number of indicators Tolerance : ±0.4mm

3L LED Indicator

ACCESSORIES

Connector (appended)

Housing : XHP-4

Contact Pin : SXH-001T-P0.6

Part No. 3L-0922

(Japan Solderless Terminal Mfg. made)

※Connector (1 housing & 4 contact pins) to be appended.

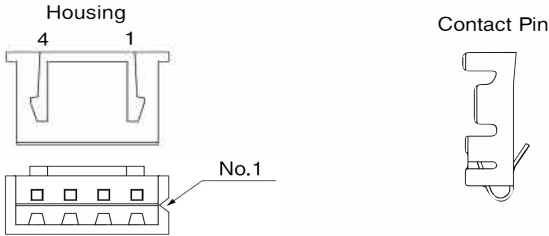

Wire Harness

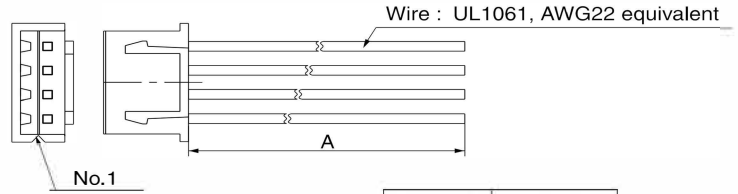

Pin no.	1	2	3	4
Color	Brown	Red	Orange	Yellow

A Length	Part No.
50cm	3L-0921-1
100cm	3L-0921-2

Joint wiring bar

Part No. 3L-0892-1

Part No. 3L-0892-2

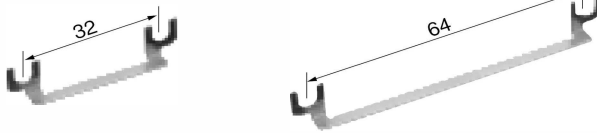

For matrix joint wiring (Screw type only).

Terminal protection cover (appended with screw type)

Part No. 3L-0884

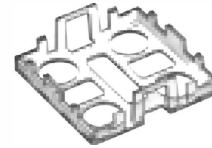

ORDERING CODE

3L —

--	--

1	2
---	---

--	--

1	2
---	---

--	--

--	--

--	--

--	--

--	--

● SHAPE & ILLUMINATION

S0	30mm square, Mono-color
S2	30mm square, Split, Horiz.
S3	30mm square, Dual-color
W0	30×62mm Rectangular, Mono-color
W1	30×62mm Rectangular, Split, Vert.
W2	30×62mm Rectangular, Split, Horiz.
W3	30×62mm Rectangular, Dual-color

● LED COLOR ※3)

7	Red	Mono-color : Put color no. into the frame 1 Split-Face : Put color no. into the frame 1, 2
8	Green	
9	Yellow	
★ 14	S.Blue	Dual-Color : Put color no. into the frame 1, 2 combination : 78, 79, 714,716, 718, 89, 814, 816, 818, 914, 916, 918, 1416, 1418, 1618
★ 16	S.White	
★ 18	S.Green	

※ "Yellow" color for LED/Filter is actually "Orange Yellow".

★ S.Blue, S.White, S.Green=Super LED(high bright)

● NOTES

※ 1) In case of Negative illumination, please select Milk-White filter.
(Black silk printing to be applied on Milk-White filter)

※ 2) Low bright type is only for Mono-color type.

※ 3) In case of Split-Face, LED and Filter color location should be specified as follow.

30mm square, Split, Horiz. 30×62mm Rectangular, Split, Vert. 30×62mm Rectangular, Split, Horiz.

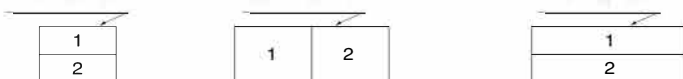

※ 4) Snap-spring metal plates come out Left/Right direction for Vertical Mounting, and Top/Bottom direction for Horizontal Mounting to avoid interfering mutually in case of serial mounting. Therefore, in case of independent use, it does not matter. (select 2 Horizontal ordinary)

● LOW BRIGHT TYPE

1	unnecessary
2	necessary

● MOUNTING ※4)

1	For Horiz. Mtg.
2	For Vert. Mtg.

● SUPPLY VOLTAGE

1	DC5V
2	AC/DC12V
3	AC/DC24V
5	AC/DC48V

● TERMINAL

K	Connector(appended)
N	Connector(not appended)
B	Screw

● FILTER COLOR ※3)

1	Red	Split-Face : Put color no. into the frame 1, 2 3-Color : Put color no. 4 into the frame 1
2	Green	
3	Yellow	
4	Milk-White	
6	Blue	

● HOUSING COLOR

K	Black
H	Grey

● COVER

C	Transparent
SK	Semitransparent (for Negative) ※1)